

FEATURES:

- Cast brass construction.
- Thermostatic valve cartridge with cover plate: 18.30.147
- Thermostatic reverse cartridge with cover plate: 18.30.161
- 14.28 GPM @ 56 PSI top exit & 11.10 GPM bottom exit
- Meets: ASME A112.18.1-2005/CSAB125.1-2005

3/4" Thermostatic

Valve & Trim

1.002597

Venezia Handle

(1.002597T Trim Only)

NOTE: Separate shut offs required to operate system.

SIDE VIEW - INSTALLED

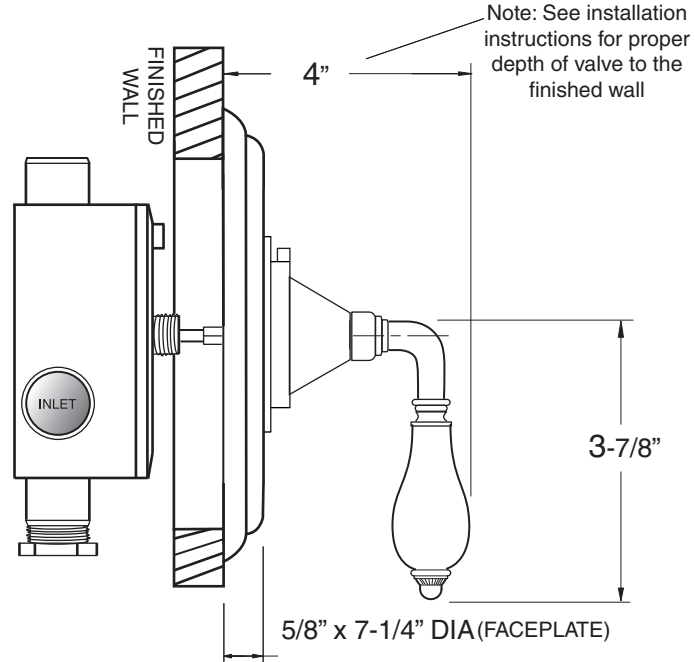

SIDE VIEW - VALVE ONLY

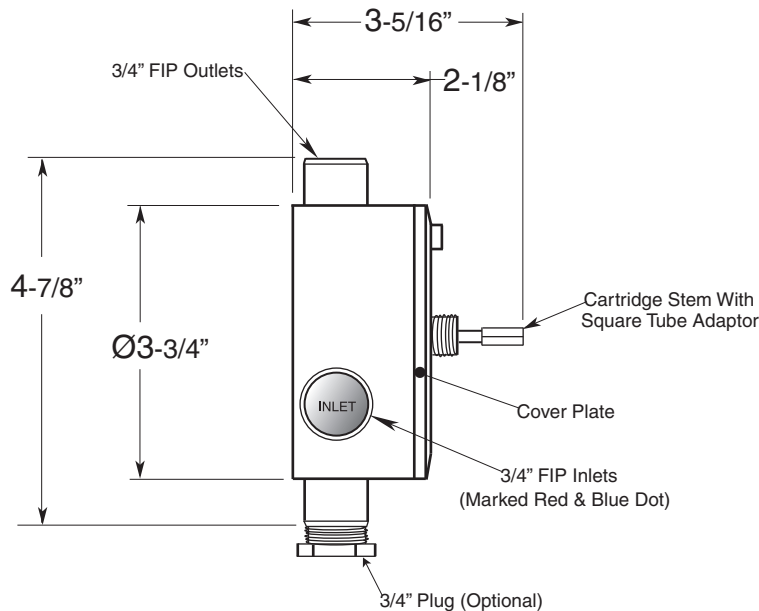

Note: Measurements are subject to change or cancellation. No responsibility is assumed for use of superseded or voided pages.

Parts List Venezia

3/4" Thermostatic
without Integral Stops

NOTE: Separate shut-offs required to operate system

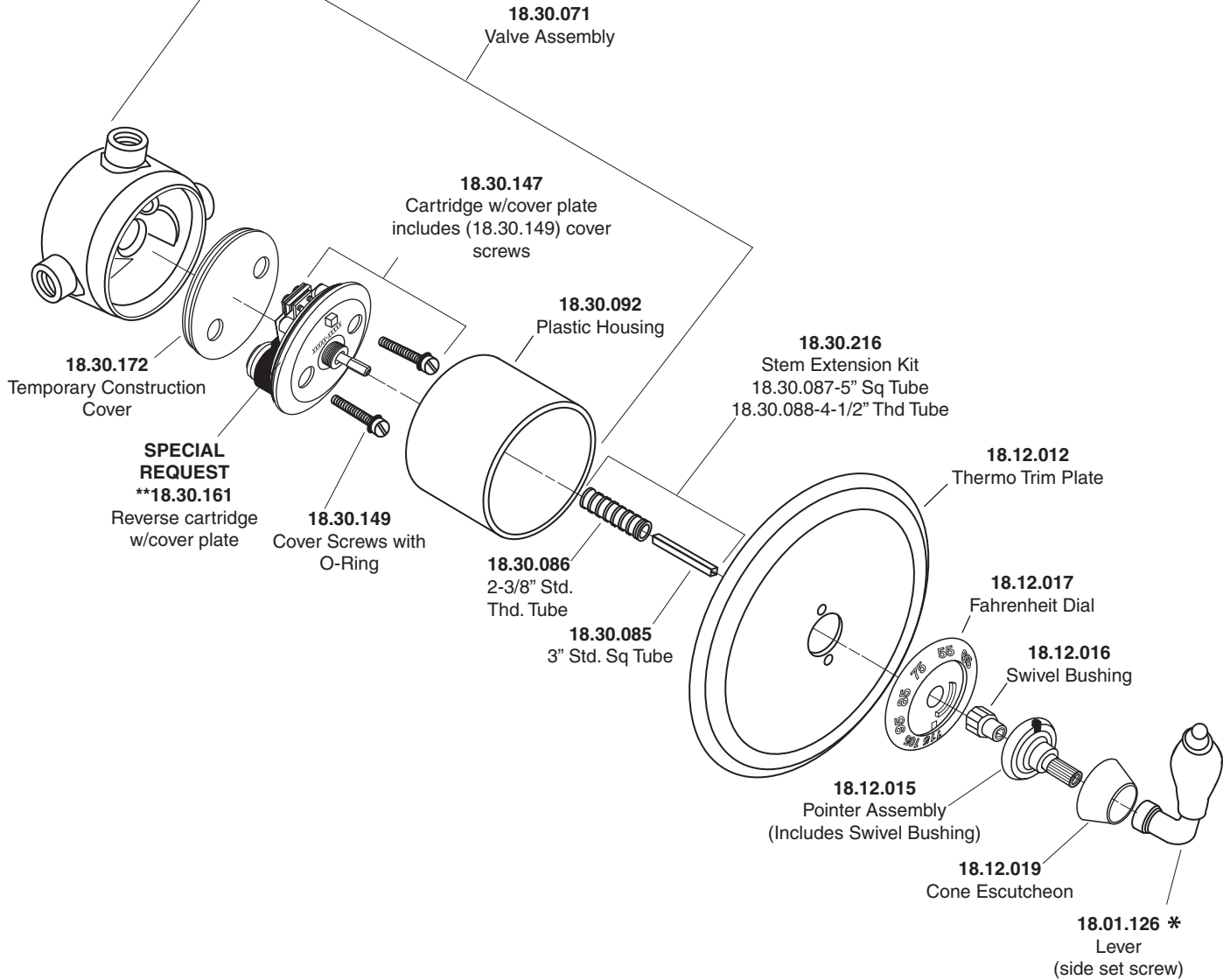

* — SPECIFY
BLACK GRANITE = B
FOREST GREEN = G
HONEY ONYX = H
WHITE CARRARA = W