

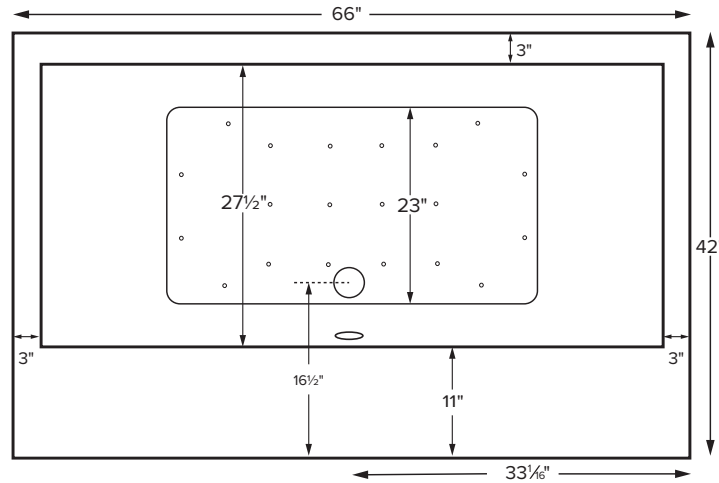

Available as a freestanding model or finished on 1, 2 or 3 sides for various installation applications.

Metro 3
with Sculpted Finish®

MODEL 175A	
66 x 42" x 24"	
FREESTANDING or ALCOVE <i>Not recommended as a tub/shower combination</i> 80 gal to overflow	
Acrylic CXL®	DoloMatte®
160 lbs / 73 kg	<SOAKER> 180 lbs / 82 kg
Filling this tub to the maximum may require an above average size or dedicated water heater.	



Features a flat 11" deck surface on the drain side for mounting faucetry. Drain kit sold separately. Shown as Air Bath

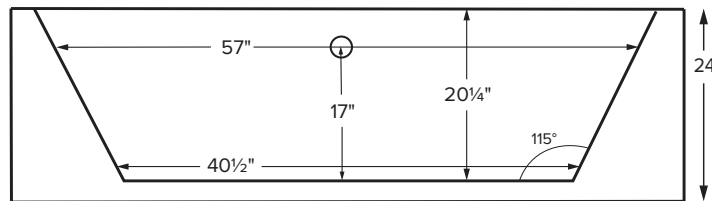

ELECTRICAL COMPONENTS & SPECIFICATIONS		
Hydrotherapy Package	Components Included	GFCI/110V
Microbubbles	Microbubbles pump	1-15 amp
Air Massage	heated blower	1-15 amp
Microbubbles with Air	Microbubbles pump, heated blower	1-20 amp
Air Massage Elite	heated blower, chromatherapy	1-15 amp
Microbubbles with Air Elite	Microbubbles pump, heated blower, chromatherapy	2-15 amp

Electrical requirements may change with the addition of optional therapy components. See specific option details or installation information. CSA Certified C/US; B45.5/IAPMO ANSI Z124.1 and ANSI 112.19.7

See the Installation & Operation Manual for more details.
MTI's Customer Service: Monday-Friday 8am-6pm EST
800-783-8827 or service@mtibaths.com

IMPORTANT ORDERING & INSTALLATION INFORMATION

- Before ordering or installing, please consider future access to equipment.
- Unless ordering Sculpted Finish on 4 sides, please include a diagram specifying which sides will need to be finished, along with location of optional tile flange(s).
- Drain is not included with this tub model.
- When ordering an air bath, the air blower must be remote mounted.
- Microbubbles system components must be installed on a non-Sculpted Finish side. Components will extend beyond the perimeter of the tub. Call MTI for specific details regarding the desired installation before placing the order.
- Radiance placed on floor locations will affect placement of air jets.
- Hydrotherapy equipment may ship loose for remote installation. See package content on the following page for details. Specifications and configurations are subject to change without notice.
- All tubs are compliant with ASTM C 1028-07 coefficient of friction. DoloMatte meets ANSI A137.1/A326.3 coefficient of friction and AS HB198:2014 slip tests.

• Options and accessories may be packaged inside the tub crate. Always check packaging before discarding.
• All product measurements are ±1/2".
• Specifications and configurations are subject to change without notice.
• Measurements herein supersede all others published prior to publication date below.



For more information on hydrotherapy packages please visit: mtibaths.com/wellness/

Metro 3
with Sculpted Finish®
MODEL 175A
66 x 42" x 24"

Hydrotherapy Packages	Package Contents	Sculpted Finish Sides	Acrylic CXL®		DoloMatte®	
			Part #	MSRP	Part #	MSRP
Soaker	Soaking bath - no jets, pre-leveled foam base	4-sides sculpted	S175A4	\$8,885	S175D4	\$9,995
		3-sides sculpted	S175A3	\$8,225	S175D3	\$9,195
		2-sides sculpted	S175A2	\$6,640	S175D2	\$7,475
		1-side sculpted	S175A1	\$6,255	S175D1	\$6,950
Microbubbles	1 infusion port, microbubbles pump, pre-leveled foam base	4-sides sculpted	n/a	n/a	n/a	n/a
		3-sides sculpted	M175A3	\$15,800	M175D3	\$16,215
		2-sides sculpted	M175A2	\$12,545	M175D2	\$12,825
		1-side sculpted	M175A1	\$9,335	M175D1	\$9,475
Air Massage	20 air jets, heated air blower, pre-leveled foam base	4-sides sculpted	AST175A4	\$12,270	AST175D4	\$13,380
		3-sides sculpted	AST175A3	\$11,610	AST175D3	\$12,580
		2-sides sculpted	AST175A2	\$10,025	AST175D2	\$10,860
		1-side sculpted	AST175A1	\$9,640	AST175D1	\$10,335
Air Massage Elite	30 air jets, heated air blower, Chromatherapy LED lighting, Spa Mode, pre-leveled foam base	4-sides sculpted	AE175A4	\$14,030	AE175D4	\$15,140
		3-sides sculpted	AE175A3	\$13,370	AE175D3	\$14,340
		2-sides sculpted	AE175A2	\$11,785	AE175D2	\$12,620
		1-side sculpted	AE175A1	\$11,400	AE175D1	\$12,095
Microbubbles with Air Massage	1 infusion port, microbubbles pump, 20 air jets, heated air blower, pre-leveled foam base	4-sides sculpted	n/a	n/a	n/a	n/a
		3-sides sculpted	ASTM175A3	\$14,130	ASTM175D3	\$15,100
		2-sides sculpted	ASTM175A2	\$12,545	ASTM175D2	\$13,380
		1-side sculpted	ASTM175A1	\$12,160	ASTM175D1	\$12,855
Microbubbles with Air Massage Elite	1 infusion port, microbubbles pump, 30 air jets, heated air blower, Chromatherapy LED lighting, Spa Mode, pre-leveled foam base	4-sides sculpted	n/a	n/a	n/a	n/a
		3-sides sculpted	AEM175A3	\$15,800	AEM175D3	\$16,770
		2-sides sculpted	AEM175A2	\$14,215	AEM175D2	\$15,050
		1-side sculpted	AEM175A1	\$13,830	AEM175D1	\$14,525

Microbubbles system components must be installed on a non-Sculpted Finish® side.

Components will extend beyond the perimeter of the tub. Call MTI for specific details regarding the desired installation before placing order.

For more customized applications, additional hydrotherapies may possibly be integrated in Sculpted Finish® tubs, depending on the types of therapy and the installation application. Visit mtibaths.com or call MTI at 800.783.8827.

RECOMMENDED SENSORY THERAPIES

Chromatherapy

(LE) **\$840** underwater lighting
2 LED lights included

Audiotherapy

(STEREOBT) **\$1,460** 2 transducers with bluetooth and amplifier
(BTREMOTE) **\$630** bluetooth remote

(STEREOH202) **\$1,655** 4 transducers
amplifier not included

Thermaltherapy

(RAD100) **\$1,675** Radiance®
2 heated zones included
Zones may be specified on Metro tub deck.



For more information on options and accessories go to Acrylic Tub Options on mtibaths.com

Metro 3 with Sculpted Finish®
MODEL 175A

Options <i>Must be ordered at time of purchase.</i>
Standard Color White (CWH) gloss Acrylic CXL, matte DoloMatte
Textured, Slip-Resistant Bottom (TXTBTM) \$110 DoloMatte® exceeds ANSI A137.1/A326.3 and AS HB198 slip tests.
Ozonator (OZONE) \$540 <i>Cannot be added to soakers or airbaths without Microbubbles system.</i>
Virtual Spout high-flow integrated tub filler (FPMJ) \$475 <i>Must be located on same side as tub deck. Specify location when ordering.</i>

Installation Options <i>Must be ordered at time of purchase.</i>	
Tile Flange Factory Installed rigid ABS 1 Side (TFK1) \$180 2 Sides (TFK2) \$195 3 Sides (TFK3) \$210 Field Install Kit (TFKNI) \$195 Includes rigid ABS & adhesive	IMPORTANT: <i>Must specify flange location(s) on order of Factory-Installed Flange.</i>

Accessories
Pillows from \$190
Teak Bath Mat (TKMAT3018) \$840 <i>Custom sizes also available. Contact MTI for details and pricing.</i>
Teak Tub Tray Slatted (TK-TRAY1) \$515 Solid (TK-TRAY2) \$585
Floor-Mounted High-Flow Tub Filler Contemporary Brushed Nickel (FILLBN) \$1,795

Drains & Overflow Kits *Toe Tap Rectangular Overflow must be ordered at time of purchase*

Cable Driven
Drain Finishes – PVC Drain Kit White/Bone/Biscuit (WOCDDW) \$460 Chrome (WOCDD) \$430 Brushed Nickel (WOCDBN) \$515 Polished Nickel (WOCDPN) \$565 Oil-Rubbed Bronze+ (WOCDDOR) \$580 Polished Brass (WOCDBR) \$725 Special Finishes* (WOCDSF) \$1,190 <i>MTI does not offer a brass body cable drain kit.</i>
Lift & Turn Drain Finishes – PVC Drain Kit Chrome (WOC) \$195 White (WOW) \$255 Brushed Nickel (WOBN) \$320

Toe Tap
Round Overflow – PVC Drain Kit Chrome (WOTTC) \$400 Brushed Nickel (WOTTBN) \$405 Polished Nickel (WOTTPN) \$405 Special Finishes* (WOTTSF) \$1,200
Round Overflow – Solid Brass Drain Chrome (WOTTSBC) \$850 Brushed Nickel (WOTTSBBN) \$850 Polished Nickel (WOTTSBPN) \$850
Rectangular Overflow – PVC Drain Kit Chrome (WOTRC) \$495 Brushed Nickel (WOTRBN) \$450 White (WOTRW) \$550

Slim-Line Overflow with Toe Tap Drain *Must be ordered at time of purchase.*

- Low profile overflow is factory installed
- Overflow measures 4.5" x 1"
- Provides a deeper soak
- Not available for commercial applications

Slim-Line Overflow with Toe Tap Drain
PVC Drain Chrome (SLOT) \$525 Brushed Nickel (SLOTBN) \$555 Polished Nickel (SLOTBN) \$585 White (SLOTW) \$450

Slim-Line Overflow with Toe Tap Drain
Solid Brass Drain Chrome (SLOTSBC) \$975 Brushed Nickel (SLOTSBBN) \$980 Polished Nickel (SLOTSBPN) \$980 White (SLOTSBW) \$1,015



Optional Slim-Line overflow

* MTI has selected an oil-rubbed bronze finish that is compatible with Delta and many other manufacturers. To ensure best match, order as a Special Finish and submit a sample.
* Allow 2-4 weeks lead time for Special Finishes. Send sample for best match.

