

# TC 65 Specifications

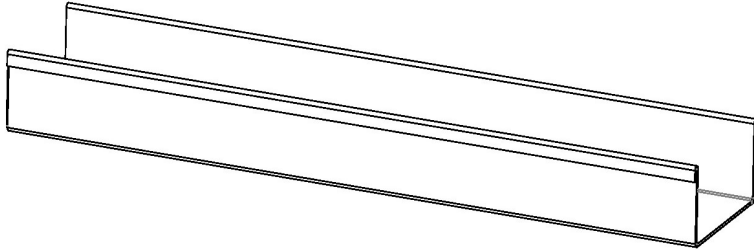

**TC 65:**

- Stainless Open Ended Channel for S-TIFAS 65 Series

**Models** (overall dimension):

- TC 6548: 48" L x 2-7/8" W x 1 5/8" H
- TC 6596: 96" L x 2-7/8" W x 1 5/8" H

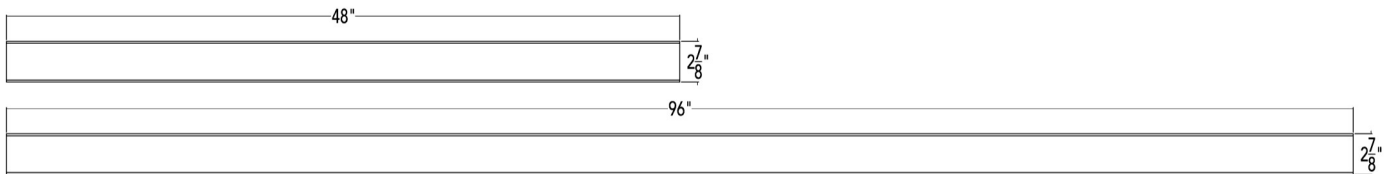
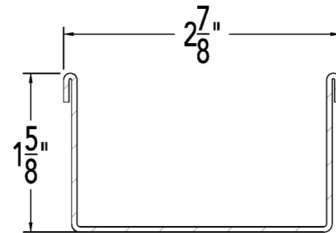

**Note:** Installer must verify all rough-in dimensions prior to installation and consult local and national codes. Conformity and compliance to local and national codes are the responsibility of the installer.

**Infinity Drain**  
18 Secatoag Avenue  
Port Washington, NY 11050  
Phone: 516.767.6786  
Fax: 516.740.3066  
www.InfinityDrain.com

