







## Tissue holder with cover

---

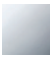
83 510 361

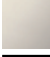

- width 145mm
- height 90 mm
- 150 mm projection

	Chrome	83 510 361-00
	Brushed Platinum	83 510 361-06
	Platinum	83 510 361-08
	Durabass (23kt Gold)	83 510 361-09
	Brushed Durabass (23kt Gold)	83 510 361-28
	Brushed Dark Platinum	83 510 361-99

## Tissue holder with cover

---

83 510 361

mm [inches]

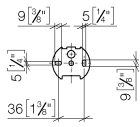
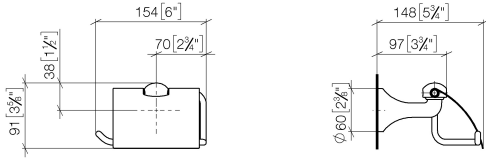

## Tissue holder with cover

83 510 361

Parts for other  
finishes can be found  
here: Brushed  
Platinum

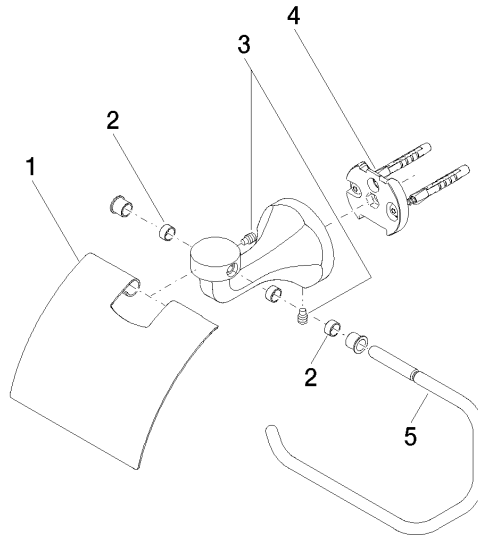

### Spare parts list

No.	Item Number	Name	Quantity used	Delivery time
1	08 11 02 508-00	lid	1	10
2	08 18 40 505 90	sleeve	2	2
3	04 31 11 140 00 90	pin	2	2
4	05 17 97 507 00 90	fixing set	1	2
5	08 18 70 501-00	bow	1	10