





**Wall valve clockwise closing cold 1/2"**

36 617 706

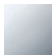

- with WAVES structure
- rosette 60 x 60 mm
- with cold marking
- head part with cut-to-length spindle and sleeve

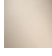
**Codes & standards**

	Chrome	36 617 706-00
	Brushed Platinum	36 617 706-06
	Dark Chrome	36 617 706-19
	Brushed Champagne (22kt Gold)	36 617 706-46
	Champagne (22kt Gold)	36 617 706-47
	Brushed Dark Platinum	36 617 706-99

**Required miscellaneous**



- Wall valve 1/2"** 35 607 970-90  
 •min. recess depth 105 mm 0010  
 •max. recess depth 150 mm

## Wall valve clockwise closing cold 1/2"

---

36 617 706

mm [inches]



### Codes & Standards

---

ADA

ASME  
A112.18.1/CSA  
B125.1

Wall valve clockwise closing cold 1/2"

36 617 706

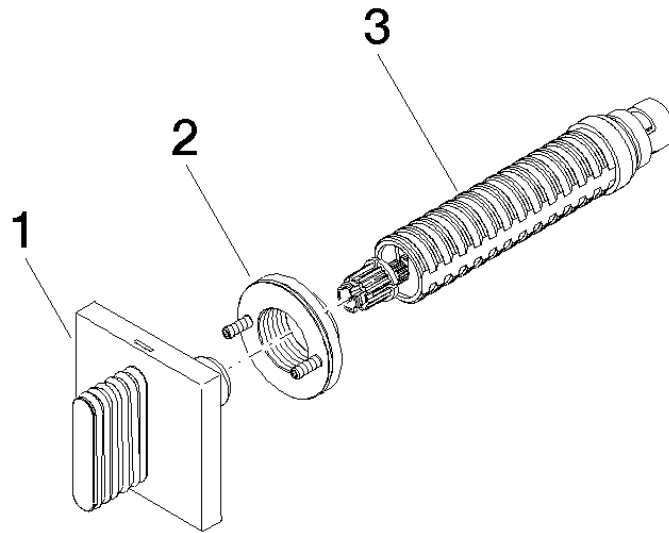

Spare parts list

No.	Item Number	Name	Quantity used	Delivery time
1	90 20 70 055 02-00	handle ( cold )	1	10
2	90 21 02 108 00 90	disc	1	2
3	90 90 03 143 00 90	top	1	2