





Wall valve clockwise closing cold 1/2"

36 607 706

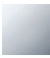

- rosette 60 x 60 mm
- with cold marking
- head part with cut-to-length spindle and sleeve

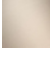
Codes & standards

	Chrome	36 607 706-00
	Brushed Platinum	36 607 706-06
	Dark Chrome	36 607 706-19
	Brushed Champagne (22kt Gold)	36 607 706-46
	Champagne (22kt Gold)	36 607 706-47
	Brushed Dark Platinum	36 607 706-99

Required miscellaneous



- Wall valve 1/2"** 35 607 970-90
 •min. recess depth 105 mm 0010
 •max. recess depth 150 mm

Wall valve clockwise closing cold 1/2"

36 607 706

mm [inches]



Codes & Standards

ADA

ASME
A112.18.1/CSA
B125.1

Wall valve clockwise closing cold 1/2"

36 607 706

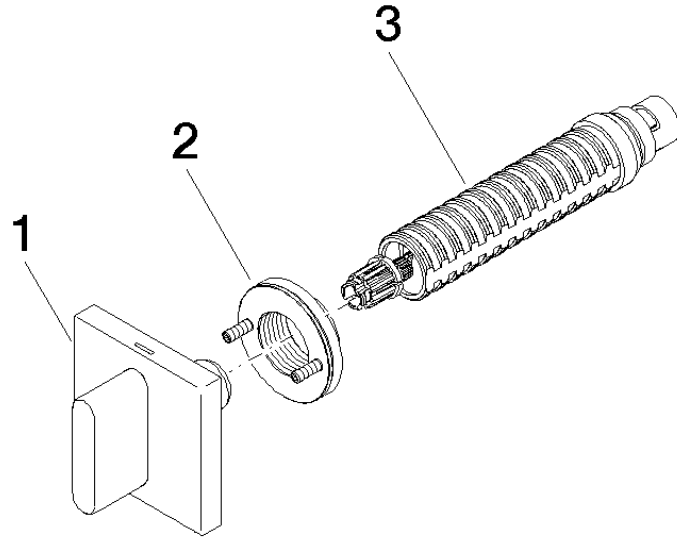

Spare parts list

No.	Item Number	Name	Quantity used	Delivery time
1	90 20 70 051 02-00	handle (cold)	1	10
2	90 21 02 108 00 90	disc	1	2
3	90 90 03 143 00 90	top	1	2