





Concealed thermostat with three function volume control

36 428 845

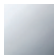

- rotary diverter with volume control and shut-off function
- cover plate 150 x 90 mm
- hot water temperature limiter, can be preset
- temperature control handle with safety limit stop at 38°C

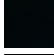
Codes & standards

	Chrome	36 428 845-00 0010
	Brushed Platinum	36 428 845-06 0010
	Dark Chrome	36 428 845-19 0010
	Matte Black	36 428 845-33 0010
	Brushed Chrome	36 428 845-93 0010

Required miscellaneous



Concealed thermostat with built-in isolators 35 428 970-90 0010
 • min. recess depth 80 mm
 • max. recess depth 136 mm

Recommended miscellaneous



xGRID Attachment set for integrating in the dry wall construction 12 340 970 90

Required miscellaneous



xGRID Installation track 555 mm 12 360 970 90

Concealed thermostat with three function volume control

36 428 845

mm [inches]

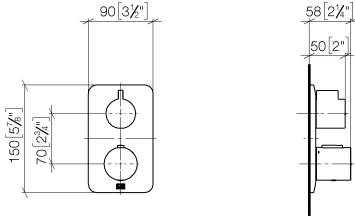

Codes & Standards

ADA

ASME
A112.18.1/CSA
B125.1

California Energy
Commission
(CEC)

Concealed thermostat with three function volume control

36 428 845

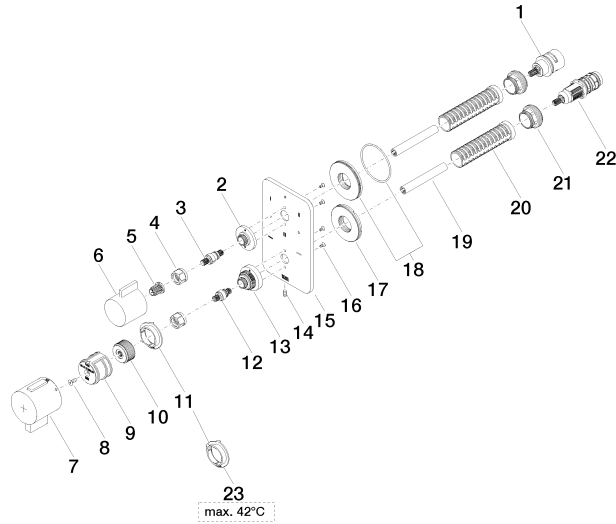



Concealed thermostat with three function volume control

36 428 845

Spare parts list

No.	Item Number	Name	Quantity used	Delivery time
1	90 90 03 170 00 90	diverter	1	2
2	09 12 12 053-00	base	1	10
3	04 29 06 111 00-00	spindle	1	60
4	09 23 30 023 90	nut	2	2
5	90 12 12 002 00 90	fixing cap	1	2
6	09 20 67 006-00	handle	1	10
7	90 17 33 019 00-00	handle	1	10
8	09 30 30 124 90	screw	1	2
9	09 12 12 052 90	base	1	2
10	09 12 12 054 90	base	1	2
11	09 28 10 190 90	regulator	1	2
12	04 29 06 024 00-00	spindle	1	60
13	09 12 12 051-00	base	1	10
14	09 31 11 134 90	pin	1	2
15	09 11 02 319-00	plate	1	10
16	09 30 30 157 90	screw	4	2
17	09 30 01 296 90	disc	1	2
18	90 30 01 190 00 90	disc	1	2
19	09 23 01 124 90	sleeve	2	2
20	09 18 40 077 90	sleeve	2	2
21	09 24 04 257 90	nut	2	2
22	90 15 02 013 00 90	cartridge	1	2
23	09 28 10 189 90	regulator	1	2