

Rain shower with ceiling fixing 300 x 240 mm



28 796 710



- rain flow
- with anti-scale system
- rain shower 300 x 240mm
- distance between ceiling and lower edge of the shower 165mm
- rosette 78 x 55, as required
- 1/2" connection
- max. flow 6.8 l/min
- quick clearing

Codes & standards

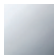
- This product reduces water consumption by % (compared to requirements of EPAct '92)
- This product can contribute to Water Use Reduction in LEED® Green Building Rating
- This product can help a building to meet requirements of Green Building Rating Systems, e.g. LEED®, BREEAM®, DGNB, WELL

	Chrome	28 796 710-00 0010
	Brushed Platinum	28 796 710-06 0010

Required miscellaneous



- | | |
|-----------------------------|---------------|
| Concealed wall elbow | 35 085 970-90 |
| • min. recess depth 90 mm | 0010 |
| • max. recess depth 163 mm | |

Rain shower with ceiling fixing 300 x 240 mm

28 796 710

mm [inches]

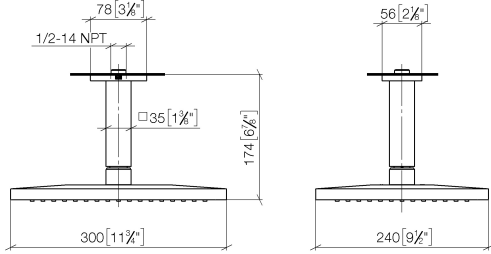

Flow rate chart

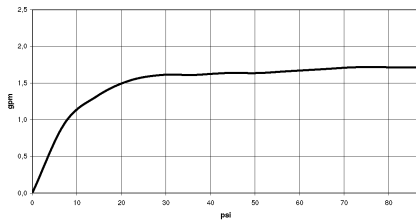

Codes & Standards

ASME
A112.18.1/CSA
B125.1

California Energy
Commission
(CEC)

Rain shower with ceiling fixing 300 x 240 mm

28 796 710

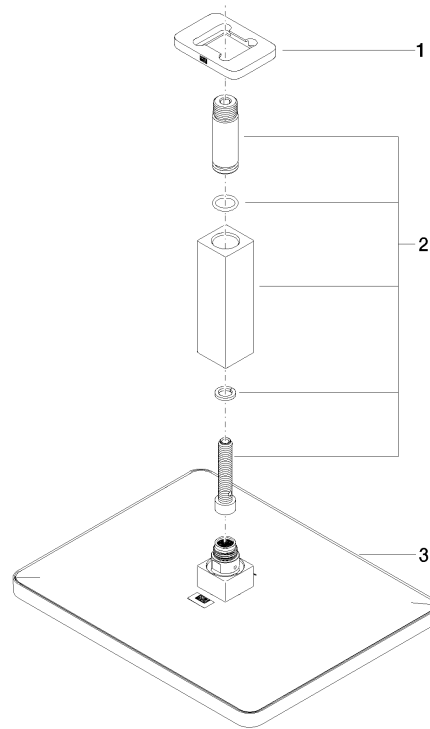

Spare parts list

No.	Item Number	Name	Quantity used	Delivery time
1	09 27 71 020-00	rosette	1	10
2	90 11 10 092 00-00	connection	1	10
3	04 12 05 062 10-00	shower	1	10