

## Rain shower with ceiling fixing 300 x 240 mm

28 775 980



- rain flow
- with anti-scale system
- rain shower 300 x 240mm
- distance between ceiling and lower edge of the shower 165mm
- rosette 60 x 60, as required
- 1/2" connection
- max. flow 6.8 l/min

### Codes & standards

- This product reduces water consumption by % (compared to requirements of EPAct '92)
- This product can contribute to Water Use Reduction in LEED® Green Building Rating

	Chrome	28 775 980-00 0010
	Brushed Platinum	28 775 980-06 0010
	Platinum	28 775 980-08 0010
	Dark Chrome	28 775 980-19 0010
	Brushed Durabronze (23kt Gold)	28 775 980-28 0010
	Matte Black	28 775 980-33 0010
	Brushed Champagne (22kt Gold)	28 775 980-46 0010
	Champagne (22kt Gold)	28 775 980-47 0010
	Brushed Chrome	28 775 980-93 0010
	Brushed Dark Platinum	28 775 980-99 0010

### Required miscellaneous



#### Concealed wall elbow

- min. recess depth 90 mm
- max. recess depth 163 mm

35 085 970-90  
0010



## Rain shower with ceiling fixing 300 x 240 mm

---

28 775 980

mm [inches]

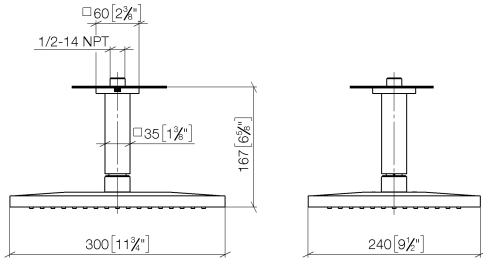

## Flow rate chart

---

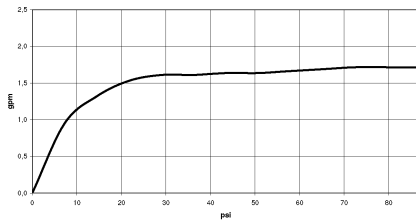

## Codes & Standards

---

ASME  
A112.18.1/CSA  
B125.1

California Energy  
Commission  
(CEC)

## Rain shower with ceiling fixing 300 x 240 mm

28 775 980

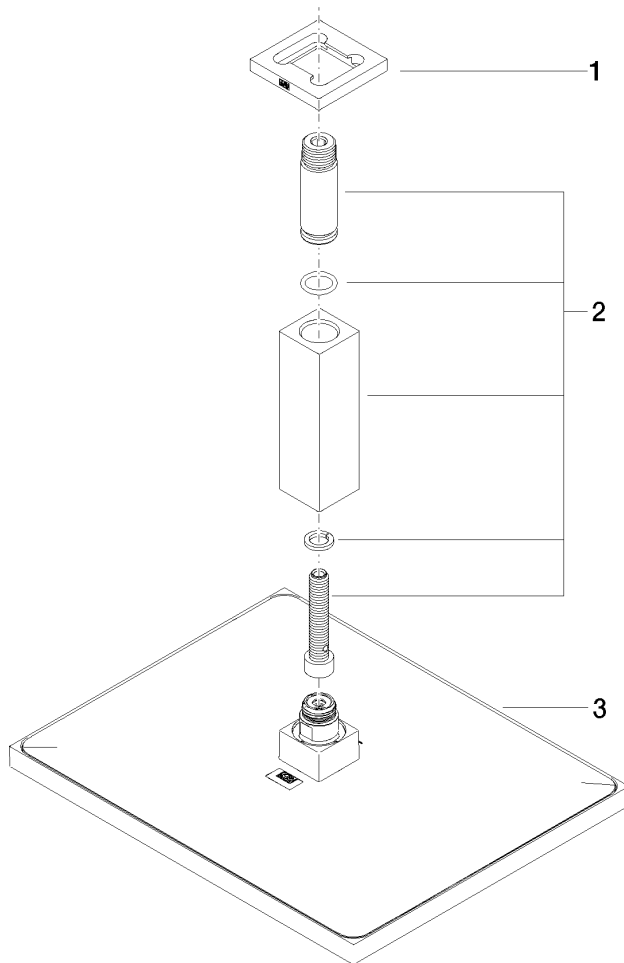

### Spare parts list

No.	Item Number	Name	Quantity used	Delivery time
1	09 27 98 017-00	rosette	1	10
2	90 11 10 092 00-00	connection	1	10
3	04 12 05 063 10-00	shower	1	10