

Hand shower FlowReduce

28 002 978







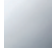

- three settings: normal flow, soft flow, massage flow
- with anti-scale system
- spray head Ø 95mm
- 1/2" connection
- max. flow 6.8 l/min

Codes & standards

- This product can help a building to meet requirements of Green Building Rating Systems, e.g. LEED®, BREEAM®, DGNB, WELL

Intrinsic protection against back flow.

	Chrome	28 002 978-00 0010
	Brushed Platinum	28 002 978-06 0010
	Platinum	28 002 978-08 0010
	Durabrand (23kt Gold)	28 002 978-09 0010
	Brushed Durabrand (23kt Gold)	28 002 978-28 0010
	Brushed Chrome	28 002 978-93 0010
	Brushed Dark Platinum	28 002 978-99 0010



Hand shower FlowReduce

28 002 978

mm [inches]

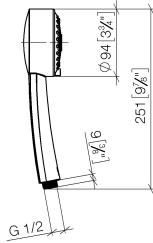

Flow rate chart

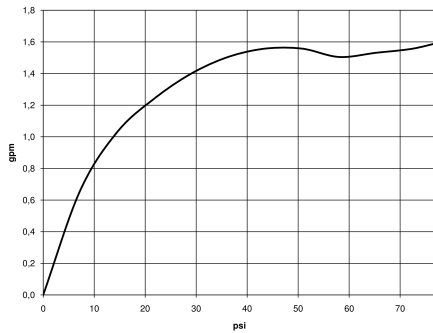

Codes & Standards

California Energy
Commission
(CEC)

Hand shower FlowReduce

28 002 978

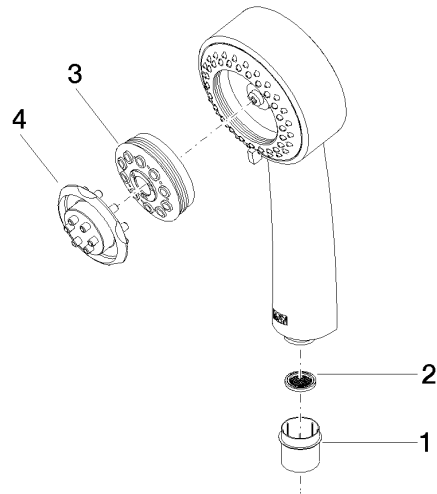

Spare parts list

No.	Item Number	Name	Quantity used	Delivery time
1	09 21 02 115 90	cap	1	2
2	09 23 01 039 90	sieve	1	2
3	04 12 11 071 00 90	shower	1	2
4	09 30 09 022 90	key	1	2