

Bath shower set for bath rim or tile edge installation

27 512 882





- 220 mm projection
- complete hand shower set: normal flow
- spout: circular, air-enriched flow
- complete hand shower set with anti-scale system
- with anti-scale system
- automatic bath/shower diverter
- height of mixer 290 mm
- height up to aerator 135 mm
- hole diameter valve 32 mm
- hole diameter spout 32 mm
- hole diameter for complete hand shower set 32 mm
- rosette for spout Ø 55mm
- rosette for complete hand shower set Ø 50mm
- rosette for deck valve Ø 55mm
- metal shower hose 1750mm with integrated anti-twist protection
- max. flow 23.5 l/min at 3 bar flow pressure
- max. flow for complete hand shower set 6.8 l/min
- WRAS: 1702041

Codes & standards

Note: Local building codes may require the use of an anti-scald device. Please refer to remote pressure balance valve (35 910 970 90)

Available with 260 mm or 300 mm projection on request (x-TRA SERVICE).

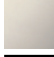
Intrinsic protection against back flow.

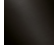
	Chrome	27 512 882-00
	Brushed Platinum	27 512 882-06
	Platinum	27 512 882-08
	Matte White	27 512 882-10
	Dark Chrome	27 512 882-19
	Brushed Durabronze (23kt Gold)	27 512 882-28
	Matte Black	27 512 882-33
	Brushed Champagne (22kt Gold)	27 512 882-46
	Champagne (22kt Gold)	27 512 882-47
	Brushed Chrome	27 512 882-93
	Brushed Dark Platinum	27 512 882-99

Bath shower set for bath rim or tile edge installation

27 512 882

Parts for other finishes can be found here: [Brushed Platinum](#)

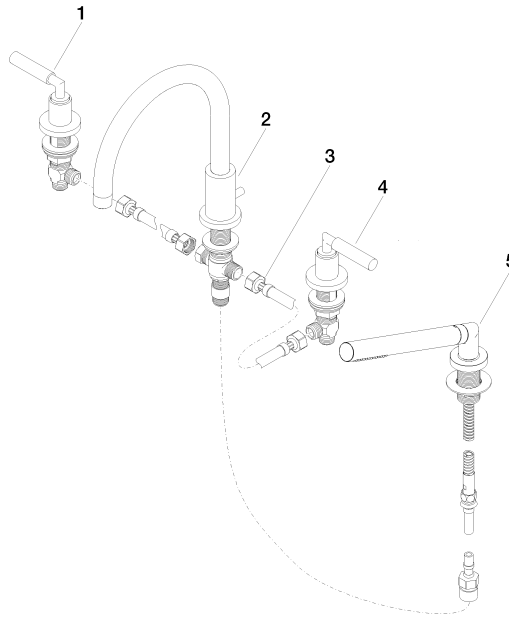

Spare parts list

No.	Item Number	Name	Quantity used	Delivery time
1	20 000 882-00	Deck valve clockwise closing	1	-
2	13 512 892-00	spout	1	10
3	12 502 970 90	High pressure hose 1/2" x 1/2" x 400 mm	2	2
4	20 000 883-00	Deck valve anti-clockwise closing	1	-
5	27 702 979-00	Hand shower set for bath rim or tile edge installation	1	10