

## Deck valve clockwise closing hot

20 000 808



- hole diameter 32 mm
- rosette Ø 60 mm
- with hot marking
- WRAS: 1802012

**Codes & standards**

	Chrome	20 000 808-00
	Brushed Platinum	20 000 808-06
	Platinum	20 000 808-08
	Dark Chrome	20 000 808-19
	Brushed Durabronze (23kt Gold)	20 000 808-28
	Brushed Champagne (22kt Gold)	20 000 808-46
	Champagne (22kt Gold)	20 000 808-47
	Brushed Dark Platinum	20 000 808-99

**Deck valve clockwise closing hot**

20 000 808

mm [inches]

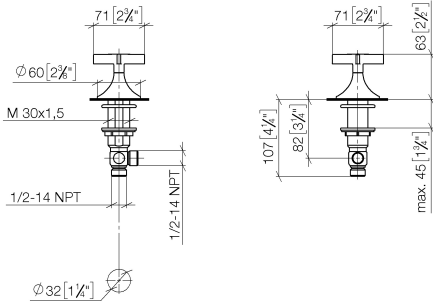

**Flow rate chart**

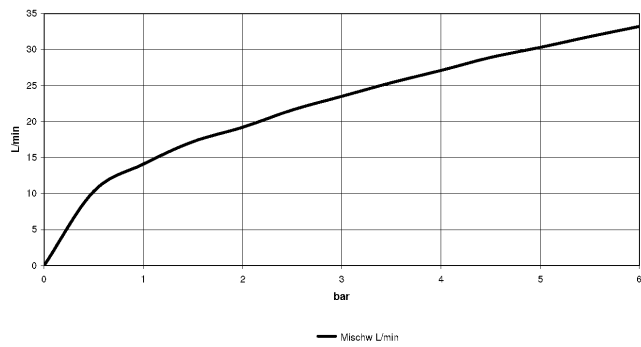

**Codes & Standards**

ADA

ASME  
A112.18.1/CSA  
B125.1

## Deck valve clockwise closing hot

20 000 808

Parts for other finishes can be found here: [Brushed](#)  
[Platinum](#)

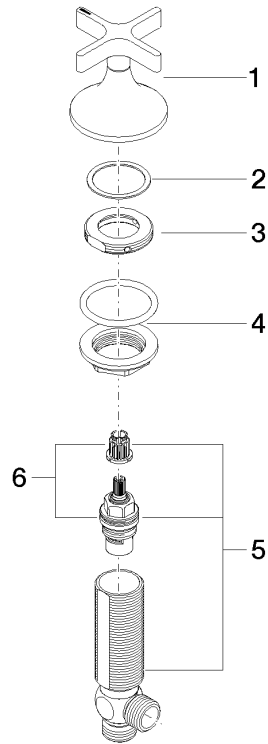

### Spare parts list

No.	Item Number	Name	Quantity used	Delivery time
1	90 20 80 011 00-00	handle ( hot )	1	10
2	09 28 10 003 90	ring	1	2
3	09 24 01 028 90	ring	1	2
4	04 23 10 032 46 90	fixing set	1	2
5	04 17 11 055 31 90	side panel	1	2
6	90 90 03 131 00 90	top	1	2