



Bath spout for wall mounting

13 801 670

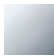

- 200 mm projection
- rectangular normal flow
- hole diameter 37 mm
- 1/2" connection
- max. flow 25.1 l/min at 3 bar flow pressure

Codes & standards

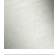
	Chrome	13 801 670-00
	Brushed Platinum	13 801 670-06
	Brushed Chrome	13 801 670-93

Required miscellaneous

Concealed adapter

35 080 970-90
0010



Bath spout for wall mounting

13 801 670

mm [inches]

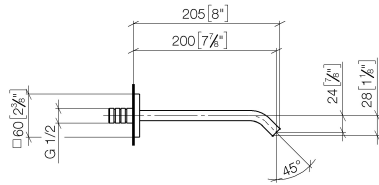

Flow rate chart

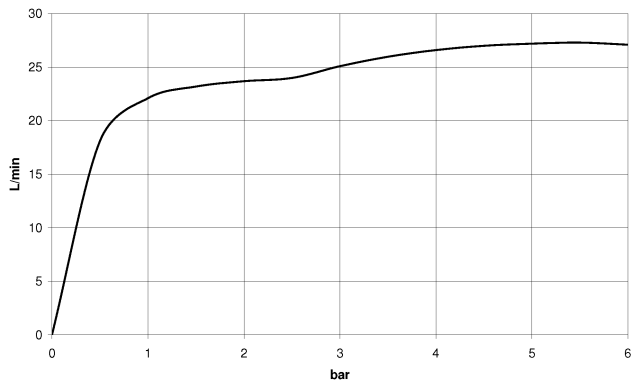

Codes & Standards

ASME
A112.18.1/CSA
B125.1

Bath spout for wall mounting

13 801 670

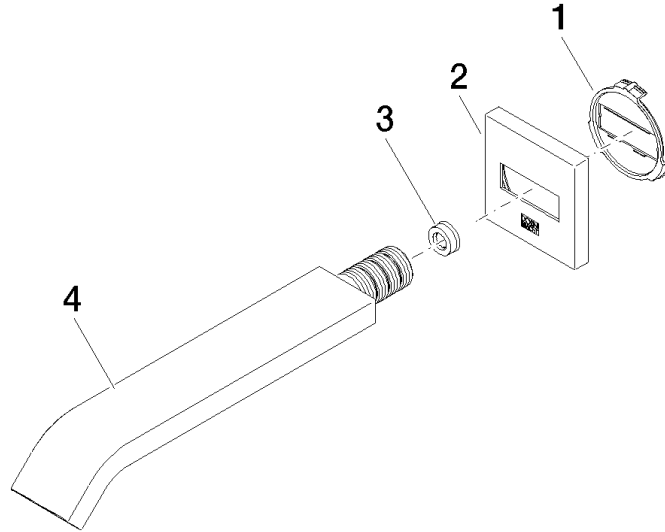

Spare parts list

No.	Item Number	Name	Quantity used	Delivery time
1	09 18 40 139 90	base	1	2
2	09 27 67 008-00	rosette	1	10
3	09 23 01 057 90	flow reducer	1	2
4	04 28 22 241 00-00	spout	1	10